

- C. C. GRIFFIN -

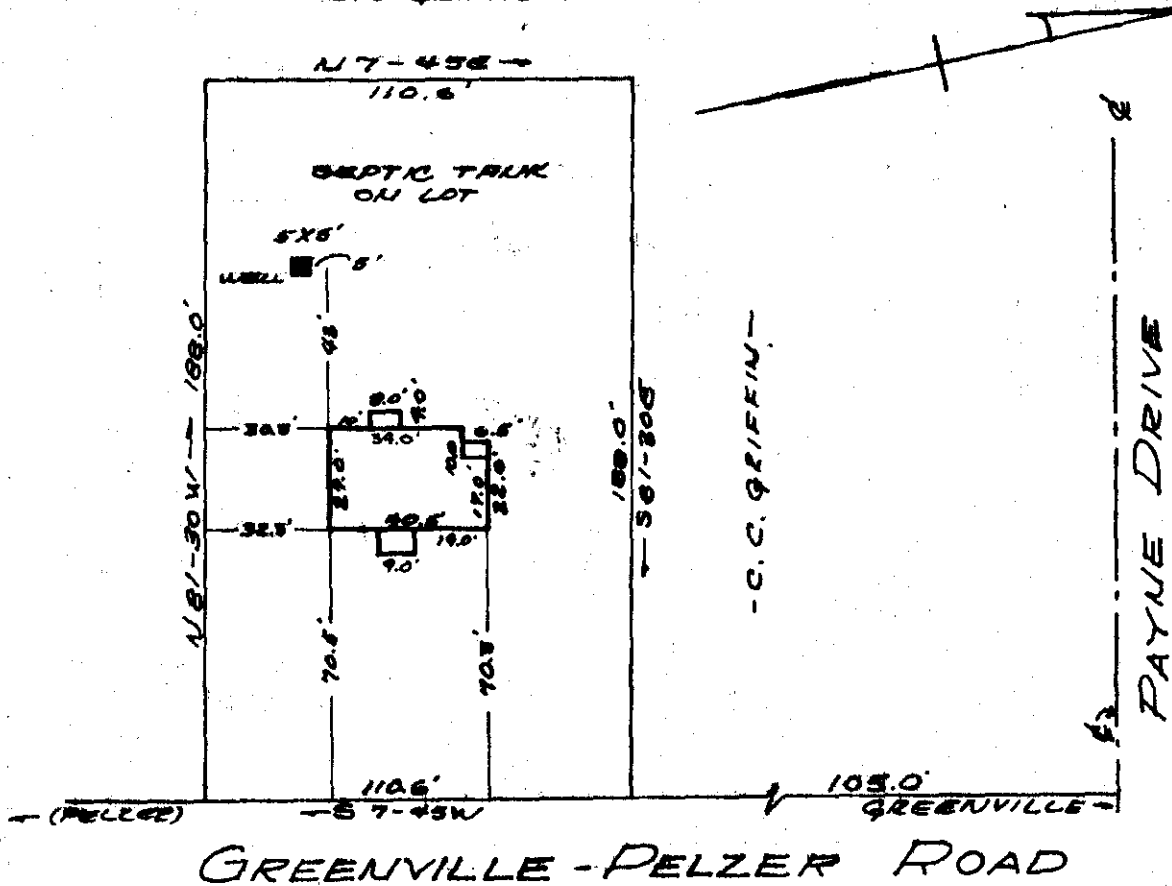

PROPERTY OF  
**JAMES R. BENNETT**  
 NEAR GREENVILLE, S.C.  
 SCALE 1" = 50' 12 JULY 1965

OLLIE HANSMORTH  
 R.M.O.

JUL 13 3 14 PM 1965

This is to certify that on the 12th day of July 1965, I surveyed the property shown on this plat, being known as the property shown on a plat recorded in the R.M.C. Office of Greenville County, S.C. in plat book "00" page 83; also being known as the property of JAMES R. BENNETT on a plat prepared by Carolina Engineering and Surveying Co. dated July 12, 1965, and recorded in the Greenville County R.M.C. Office in platbook KKK page 21; and that the property lines, walls, and buildings are as shown hereon, and that the buildings located on said lot do not encroach or project onto adjacent street or property, and that no adjacent walls or buildings encroach or project onto said premises.

B. B. Bruce  
 R.B. Bruce, R.L.S. #1952

CAROLINA ENGINEERING AND SURVEYING CO.  
 GREENVILLE, S.C.

KKK-21

JUL 13 1965

Paste in 5 of

1639 Filed This 13 day of July 1965  
 And Recorded in Vol. KKK Page 21 at 3:14 PM  
Ollie Hansworth  
 Register Mesne Conveyance Greenville County, S. C.